

TR275

220W RMS 2-Channel class-AB amplifier with active x-over



Complementary products



Optional EBC (Ref : EBC-1)



Power kit : ZNX8K ZNX10K

Examples of use

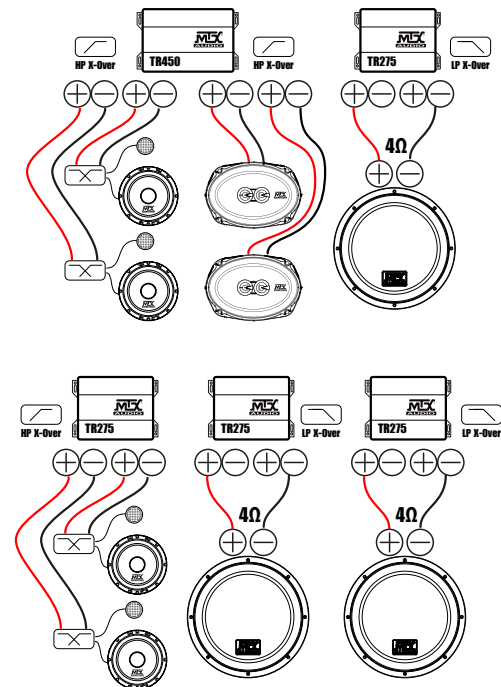

Specifications

- 2-Channel Class-AB wide range amplifier
- CEA2006 certified Power Output :
 - 2x110W RMS @2Ω and THD+N ≤1%
 - 2x75W RMS @4Ω and THD+N ≤1%
 - 1x220W RMS bridged @4Ω and THD+N ≤1%
- Crossover :
 - High pass 12dB/oct 80Hz
 - Low pass 12dB/oct 80Hz
- Signal-to-Noise Ratio (1 Watt) : > 74dB
- THD+Noise (Distortion) (1 Watt) : ≤ 0,18%
- Frequency Response (±1dB) : 10Hz-60000Hz
- Maximum Input Signal : 6V
- Maximum Sensitivity : 200mV
- Dimensions : 142x134x51mm
- High level inputs
- Optional EBC remote control (EBC-1)

Wide range Class-AB amp for speakers and subwoofer

Bridge mode for a subwoofer or an enclosure

Optimized for 2Ω loads in stereo and 4Ω loads in bridge mono

12dB/Oct high-pass or low-pass x-over for speakers or subwoofer

Full aluminum construction

Optimized for RTE12AS, RTE12AV, RTF10AS, TR12AV, RT10AS, RT12AV

Optional EBC remote control sold separately (Reference : EBC-1)

mtxaudio.eu

facebook.com/MTXEurope

twitter.com/MTXEurope